

Product ID: MKR 2424-48 DB

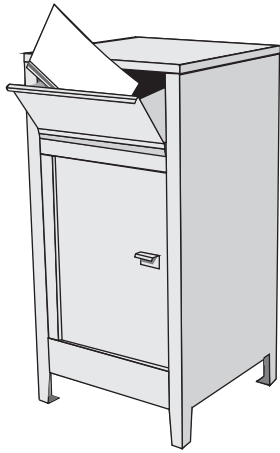

Outdoor Dropbox

SPECIFICATIONS:

- constructed from 14 gauge sheet metal
- painted with a two component epoxy primer, finished with an acrylic paint
- doors have gaskets to provide a good weather seal
- high quality 5 pin tumbler brass body camlock, master keyable
- drop chute allows for parcel size of 14" wide x 5" high x 8" deep
- legs provided with 1/2" holes for anchoring to ground
- shipping weight: 150 lbs.

APPLICATION:

- outdoor public drop box for parcels

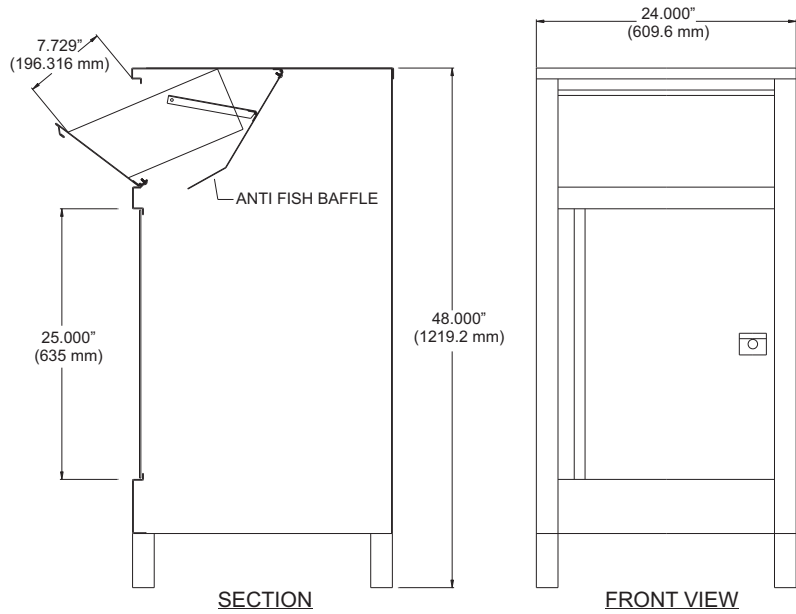

- Courier -



- Equipment -